

# 4.2.1 Wellington Rd Noise Wall Embankment

Between Hector Street and Hill Road, the homes along Wellington Street are directly adjacent to a section of noise wall. Due to its proximity to housing, this section will have a special treatment applied that 'softens' its visual impact. The special treatment includes shrubs in front of the noise wall.

- Noise wall theme:** Local Plants
- Retaining wall theme:** Bankstown
- Special treatment:** Screening Plants

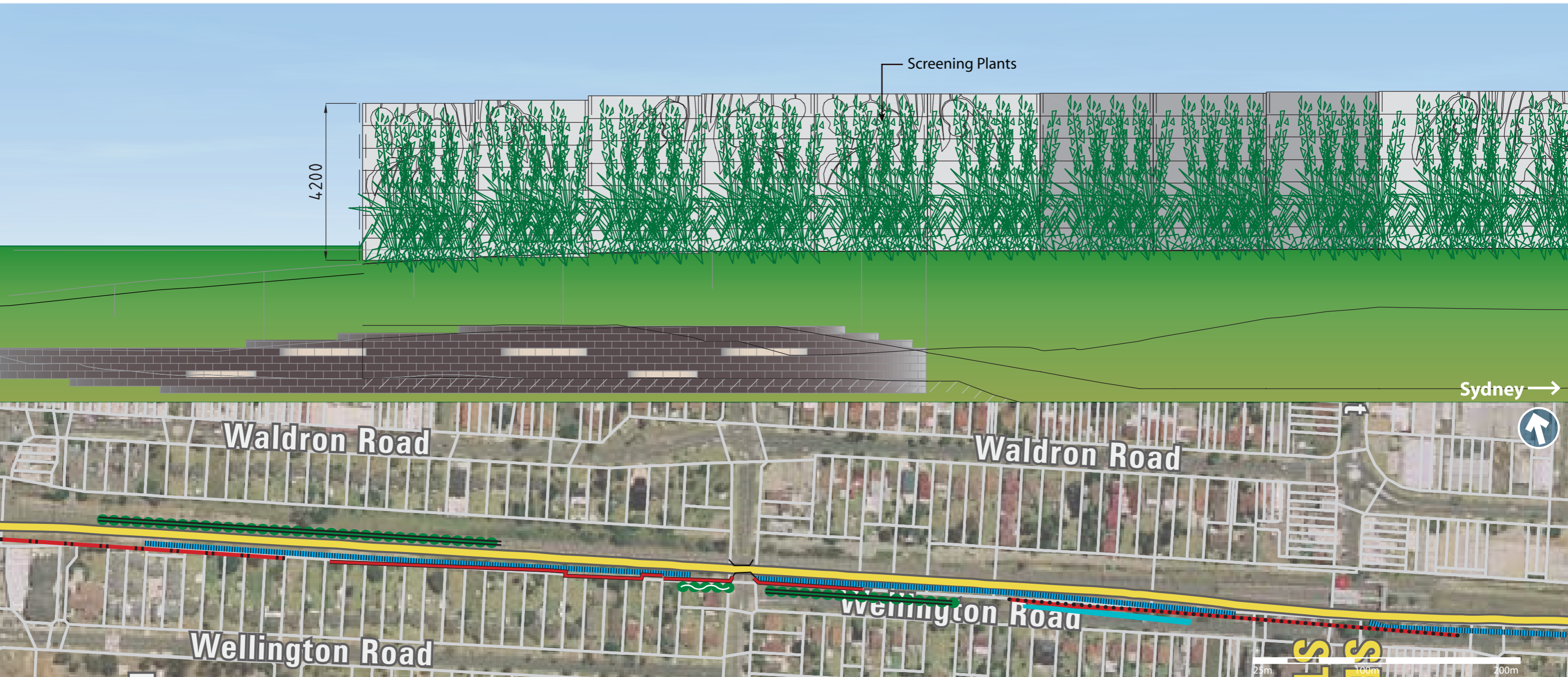

# 4.2.1 Wellington Rd Noise Wall Shadow Diagram

A shadow diagram has been prepared for the Wellington Road Noise wall between Hector Street and Hill Road. The diagrams below indicate the shadows cast by the Noise Wall on the 22nd June (Winter Solstice) at 9am, 12noon and 3pm.

Wellington Road Noise Wall  
Shadow Diagram 22nd June - 9am

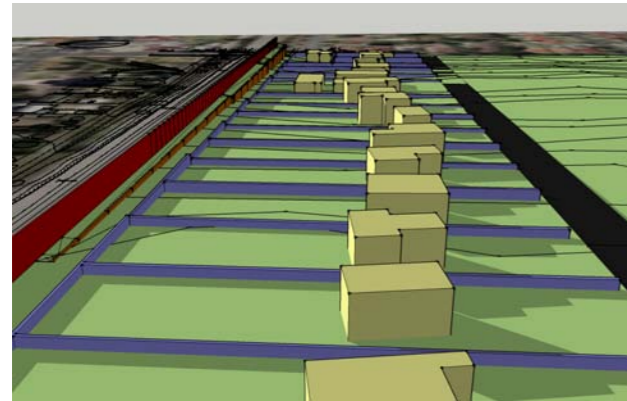

View east towards Hector Street

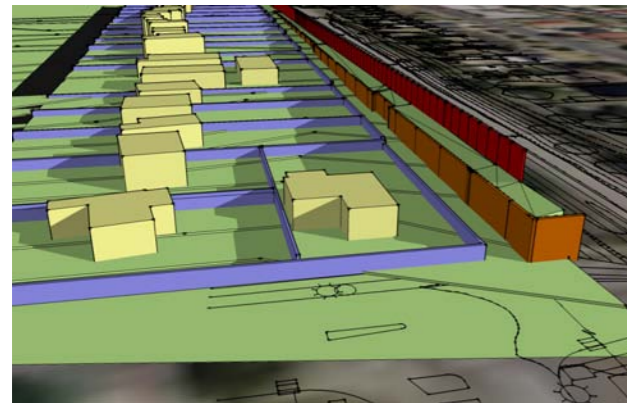

View west towards Hill Road

Plan



Wellington Road Noise Wall  
Shadow Diagram 22nd June - 12pm

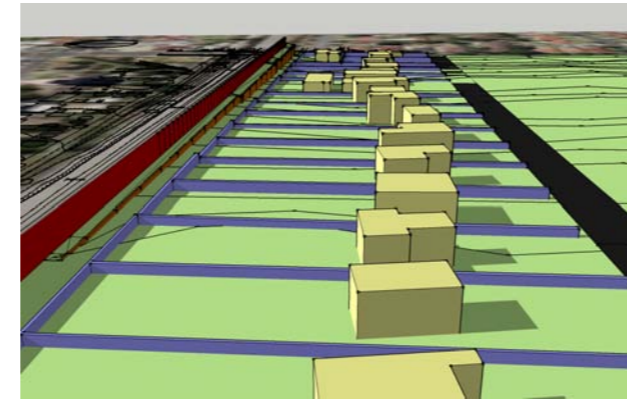

View east towards Hector Street

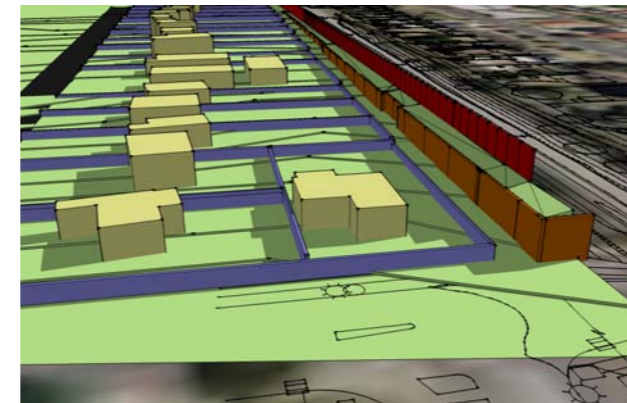

View west towards Hill Road

Plan



Wellington Road Noise Wall  
Shadow Diagram 22nd June - 3pm

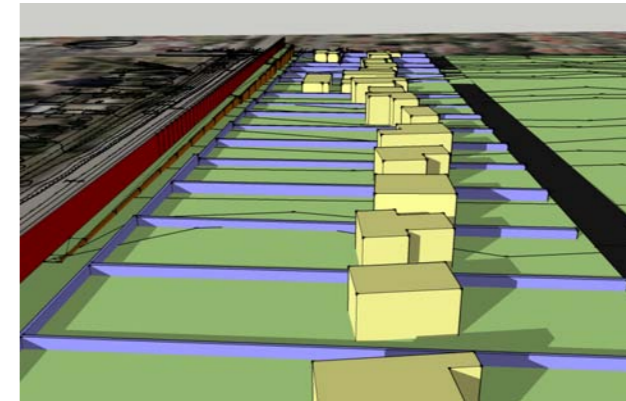

View east towards Hector Street

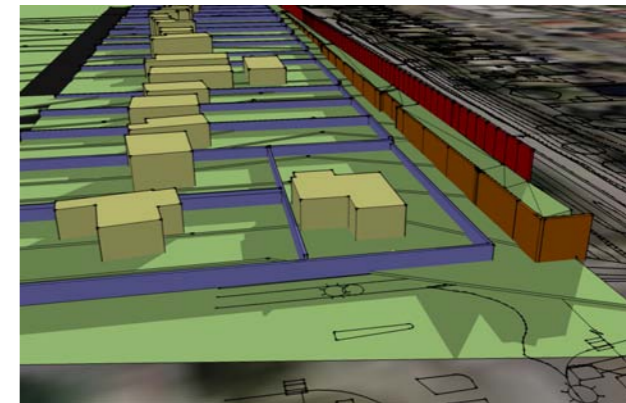

View west towards Hill Road

Plan

